

Probe Designs

ThermoProbe offers a wide variety of probe types for TP2-C, TP5-C, TP7, & TP8 thermometers:



- ▶ **STANDARD WEIGHT** - 0.25 LB (0.11 KG)
This reliable design is our most popular probe.



- ▶ **EXTRA WEIGHT** - 0.50 LB (0.23 KG)
This design has the same diameter as the Standard Weight but is slightly longer and heavier.



- ▶ **RAILCAR / NO WEIGHT**
The Railcar probe is produced as a specialty probe for the railcar industry specifically for small diameter gauging tubes fitted in many tanker cars.

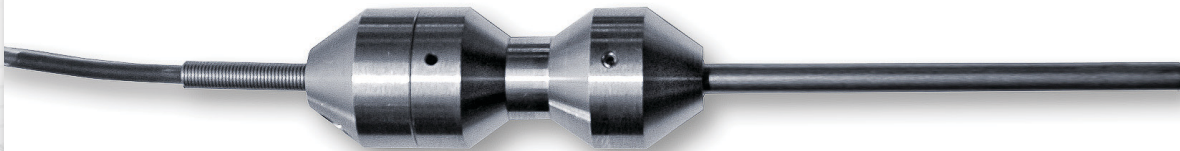

- ▶ **ASPHALT WEIGHT** - 0.75 LB (0.34 KG)
The probe of choice when working with molten asphalt, sulfur, or similar high-viscosity petrochemicals.